



Ewing Intercounty Drain

Sections 1 & 12
T13N R3W

Coe Township, Isabella County, Michigan

Sections 4 - 9
T13N R2W

Jasper Township, Midland County, Michigan

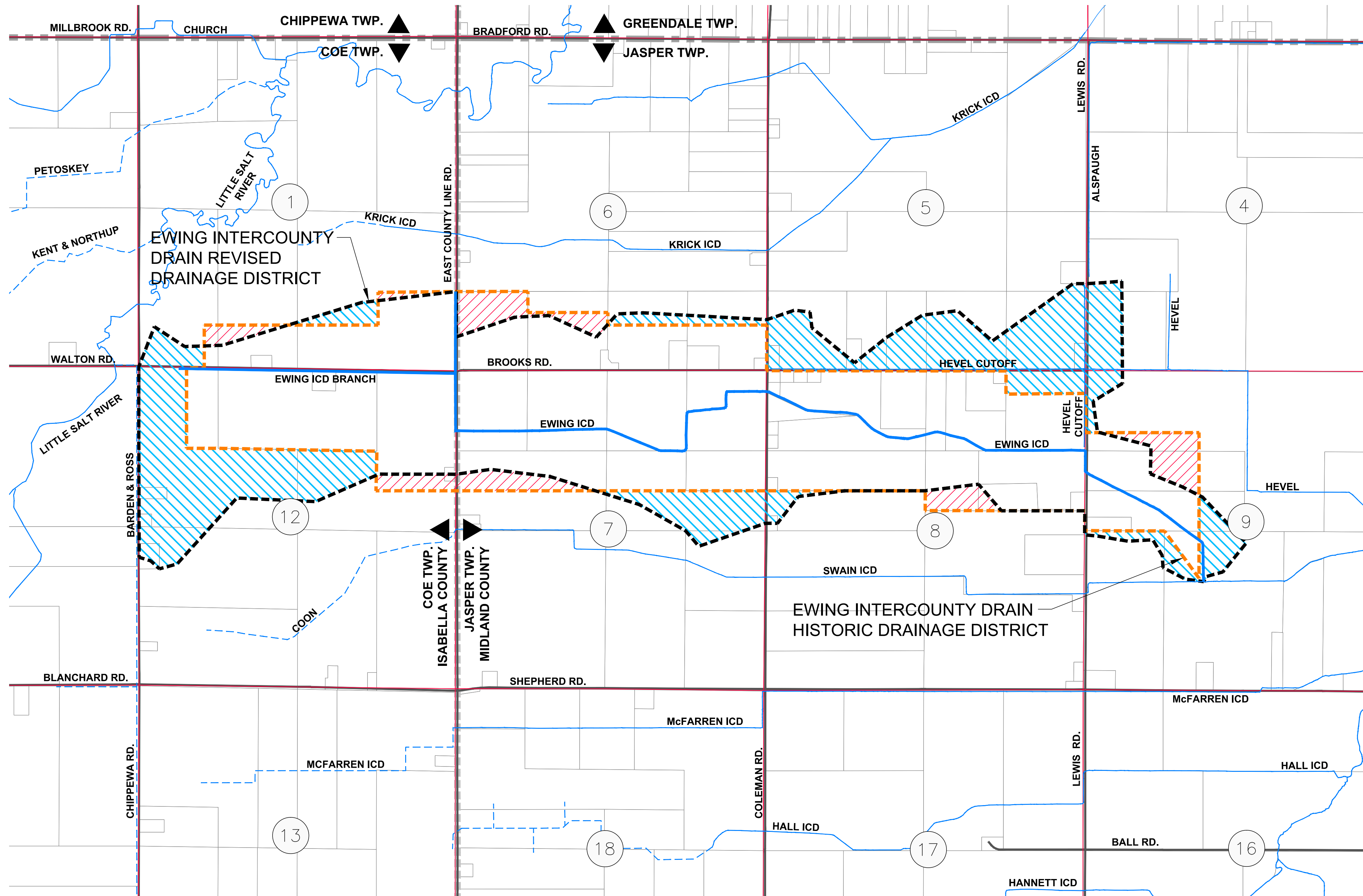

DRAINAGE DISTRICT INFORMATION:

HISTORIC DISTRICT:	914.43 ACRES
REVISED DISTRICT:	1,184.09 ACRES
LANDS ADDED:	347.99 ACRES
LANDS REMOVED:	78.33 ACRES
DRAIN LENGTH	
EWING INTERCOUNTY DRAIN	4.13 MILES

LEGEND

- LANDS REMOVED
- LANDS ADDED
- ENCLOSED DRAIN
- OPEN CHANNEL DRAIN
- HISTORIC DRAINAGE DISTRICT BOUNDARY
- REVISED DRAINAGE DISTRICT BOUNDARY
- PARCEL LINES
- ROADS
- SECTION LINES
- CITY / VILLAGE LIMITS
- TOWNSHIP LINE
- COUNTY LINE
- SECTION NUMBERS

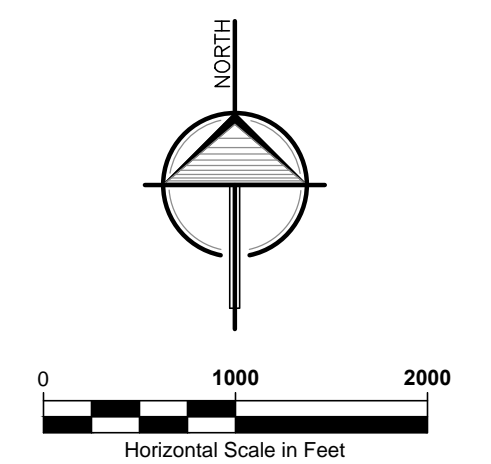

LANDS ADDED/REMOVED MAP EXHIBIT B-1

	2121 3 Mile Rd. NW Walker, MI 49544 Ph: 616-301-7888 www.LREMI.com	PROJECT#: 19-166
		DRAWN BY: KJB
		DATE: 06/24/2020
		QA/QC: MPB