



MIDLAND COUNTY DRAIN COMMISSIONER

JOSEPH SOVA
220 W. Ellsworth Street
Midland, MI 48640

DUNBAR INTERCOUNTY DRAIN

**NOTICE OF DAY OF REVIEW OF DRAINAGE DISTRICT BOUNDARIES
AND REVIEW OF APPORTIONMENTS**

DATE: Tuesday, August 30, 2022
TIME: 9:00 a.m. to 5:00 p.m.
LOCATION: County Services Building, Board Room 220
W Ellsworth Street, Floor 1
Midland, MI 48640
QUESTIONS: (989) 832-6770

The Midland County Drain Commissioner will hold a Day of Review of Drainage District Boundaries and Apportionments on the above date, time, and location. The Day of Review is an opportunity to review the Dunbar Intercounty Drain Drainage District boundaries and the tentative apportionment of benefits for each parcel and municipality within the Drainage District. A map of the proposed Drainage District boundary revisions can be found enclosed with this notice and on the Drain Commissioner's website at: <https://co.midland.mi.us/DrainCommissioner/DrainDistrictMaps.aspx>.

The Drain Commissioner, engineers, and/or other staff members will be available to assist individuals throughout the day and make revisions where necessary. There is no need to schedule an appointment for a specific time on the Day of Review. The computation of costs for the Drain will also be available at the Day of Review. Drain assessments are collected in the same manner as property taxes and will appear on your winter tax bill. If drain assessments are being collected for more than one (1) year, you may pay the assessment in full with any interest to date at any time and avoid further interest charges.

Persons with disabilities needing accommodations for effective participation in the Day of Review should contact the Drain Commissioner's Office at the number noted above (voice) or through the Michigan Relay Center at 7-1-1 (TDD) at least 24 hours in advance of the Day of Review to request mobility, visual, hearing, or other assistance.

Comments on the apportionment of benefits may be submitted to the Drain Commissioner in writing before the date of the Day of Review to the Midland County Drain Commissioner at 220 W Ellsworth Street, Midland, MI 48640 or to drain@co.midland.mi.us, or comments may be submitted in writing or verbally at the Day of Review. Comments submitted in advance must be received by the Drain Commissioner prior to the Day of Review to ensure consideration.

The following is a list of any county, township, city, or village to be assessed: Midland County and Warren Township.

You may appeal the Drain Commissioner's decision to revise the district boundary to the Midland County Circuit Court within ten (10) days, and you may also appeal the determination of apportionments to the Midland County Probate Court within ten (10) days.

Joseph Sova
Midland County Drain Commissioner

DUNBAR INTERCOUNTY DRAIN DRAINAGE DISTRICT

MICHIGAN DEPARTMENT OF AGRICULTURE AND RURAL DEVELOPMENT - BRADY HARRINGTON, PE
 GLADWIN COUNTY DRAIN COMMISSIONER - TERRY L. WALTERS
 MIDLAND COUNTY DRAIN COMMISSIONER - JOSEPH SOVA

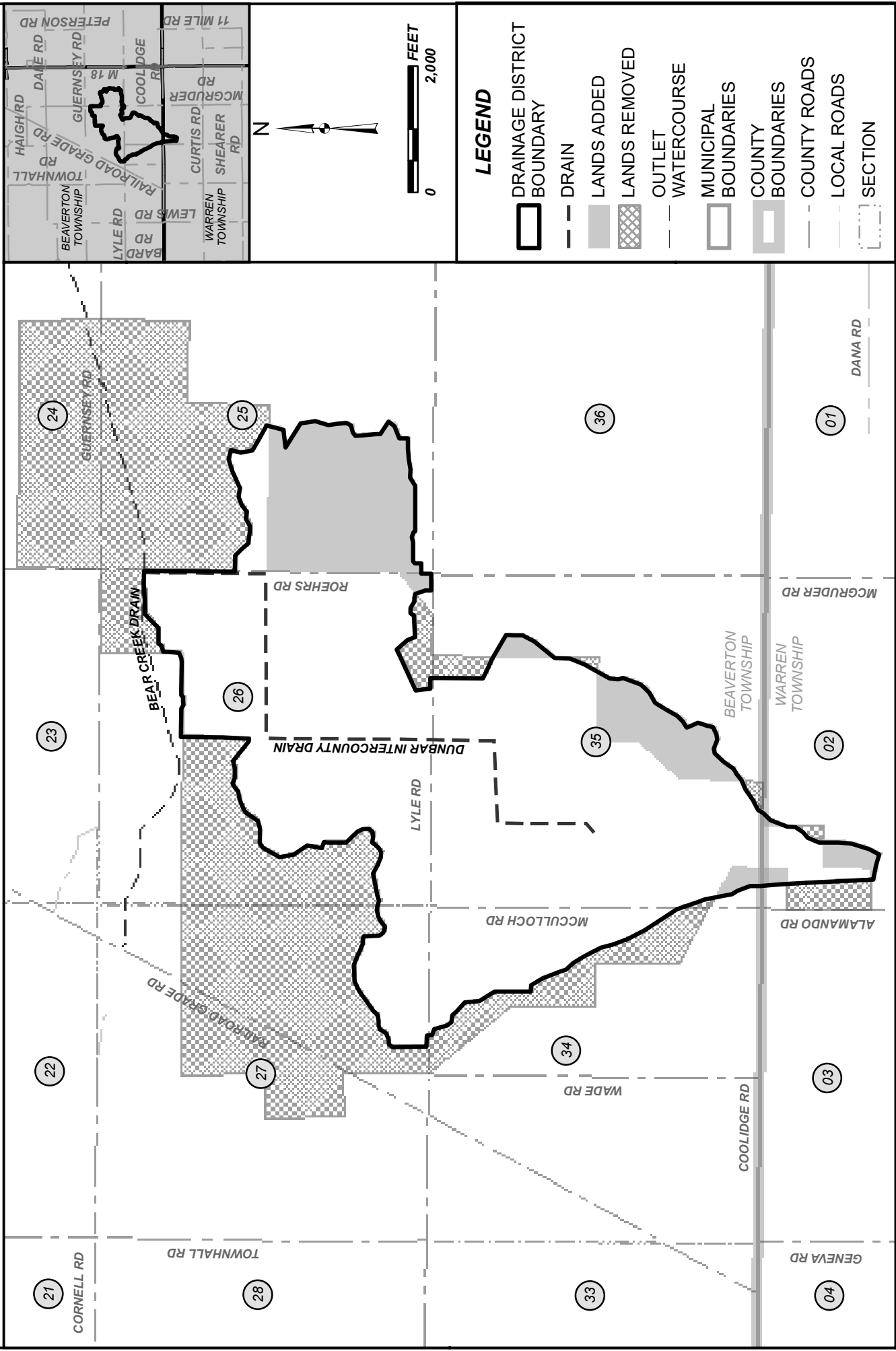

LEGEND

- DRAINAGE DISTRICT BOUNDARY
- DRAIN
- LANDS ADDED
- LANDS REMOVED
- OUTLET
- WATERCOURSE
- MUNICIPAL BOUNDARIES
- COUNTY BOUNDARIES
- COUNTY ROADS
- LOCAL ROADS
- SECTION