

MIDLAND COUNTY
Equalization Department
1212 James Sprague Road
Midland, MI 48640

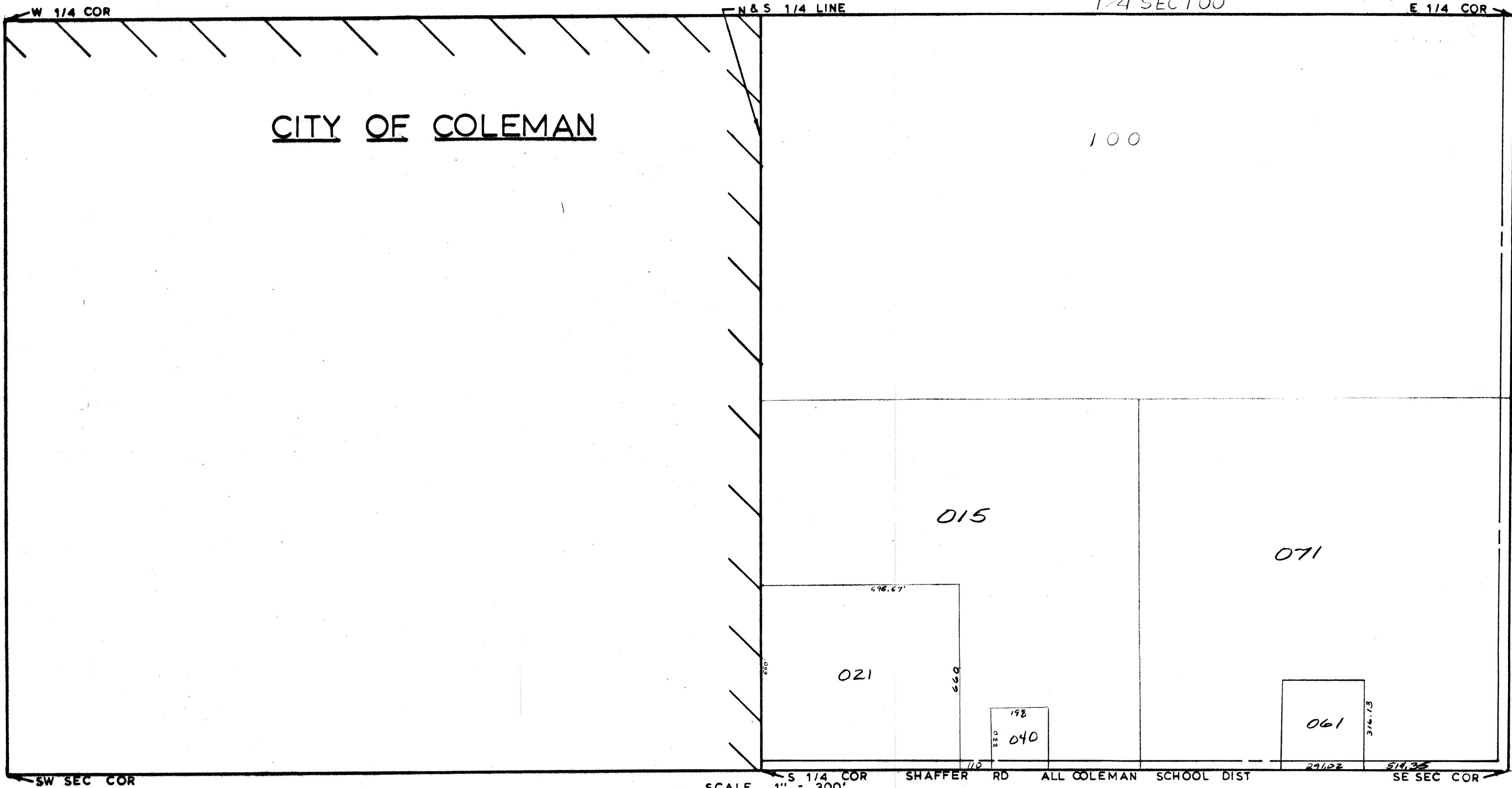

CITY OF COLEMAN

100

015

071

021

040

061

SCALE
DRAWN

1" = 300'
BY R. R. Y.

S 1/4 COR

SHAFER RD

ALL COLEMAN

SCHOOL DIST

SE SEC COR

T 16NR2W

WARREN TOWNSHIP

REV. 12-20-06
S1/2SEC20