

MIDLAND COUNTY  
Engineering Department  
1212 James George Road  
Midland, MI 48640

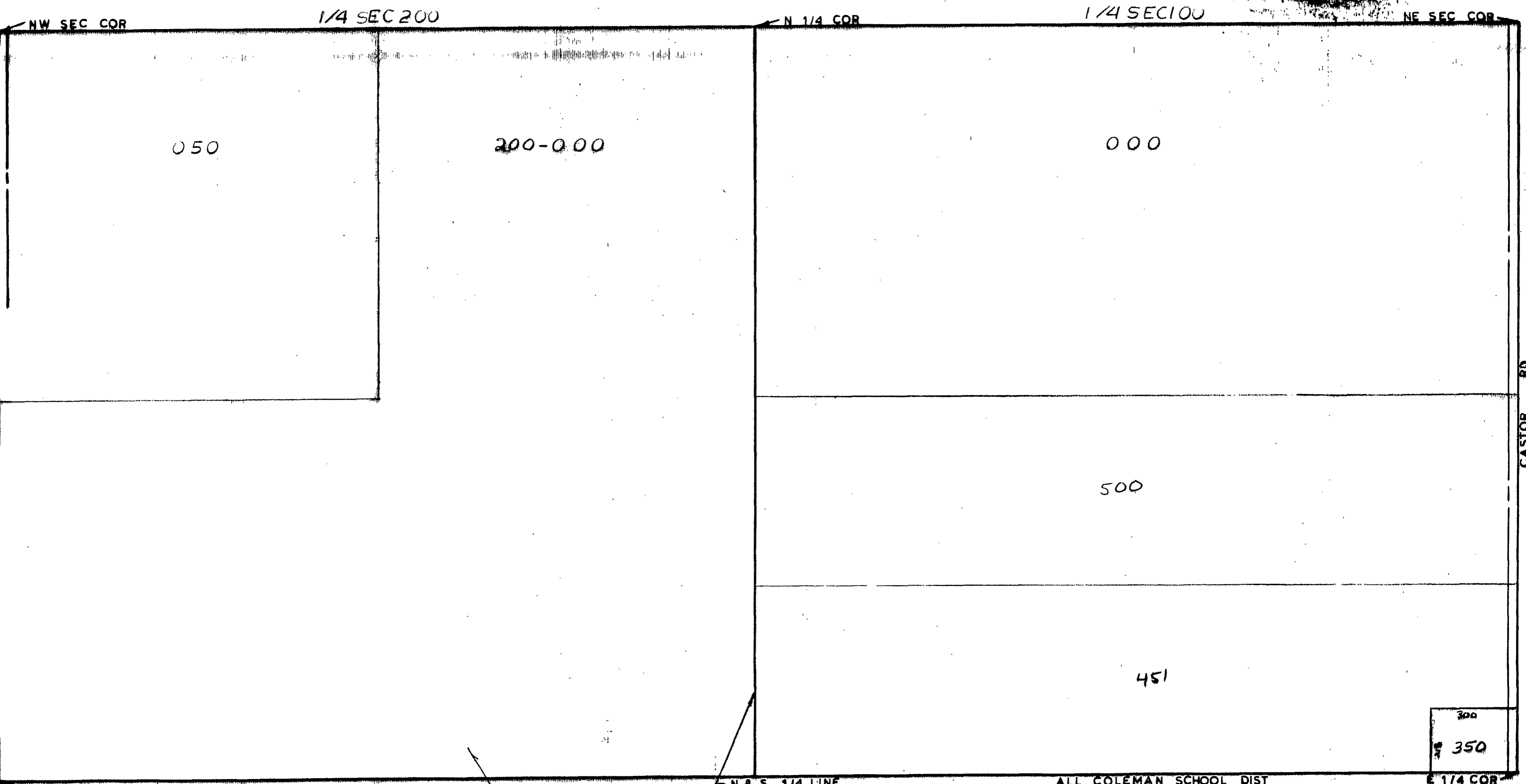

NW SEC COR

1/4 SEC 200

N 1/4 COR

1/4 SEC 100

NE SEC COR

050

200-0.00

000

500

451

300  
350

W 1/4 COR

N & S 1/4 LINE  
SCALE 1" = 300'  
DRAWN BY R.R.Y.

ALL COLEMAN SCHOOL DIST

E 1/4 COR

CASTOR RD

T15N R2W

GENEVA TOWNSHIP

REV. 11-23-98  
N1/2SEC36