

MIDLAND COUNTY
Recorder's Department
1112 James Savage Road
Mason, MT 48640

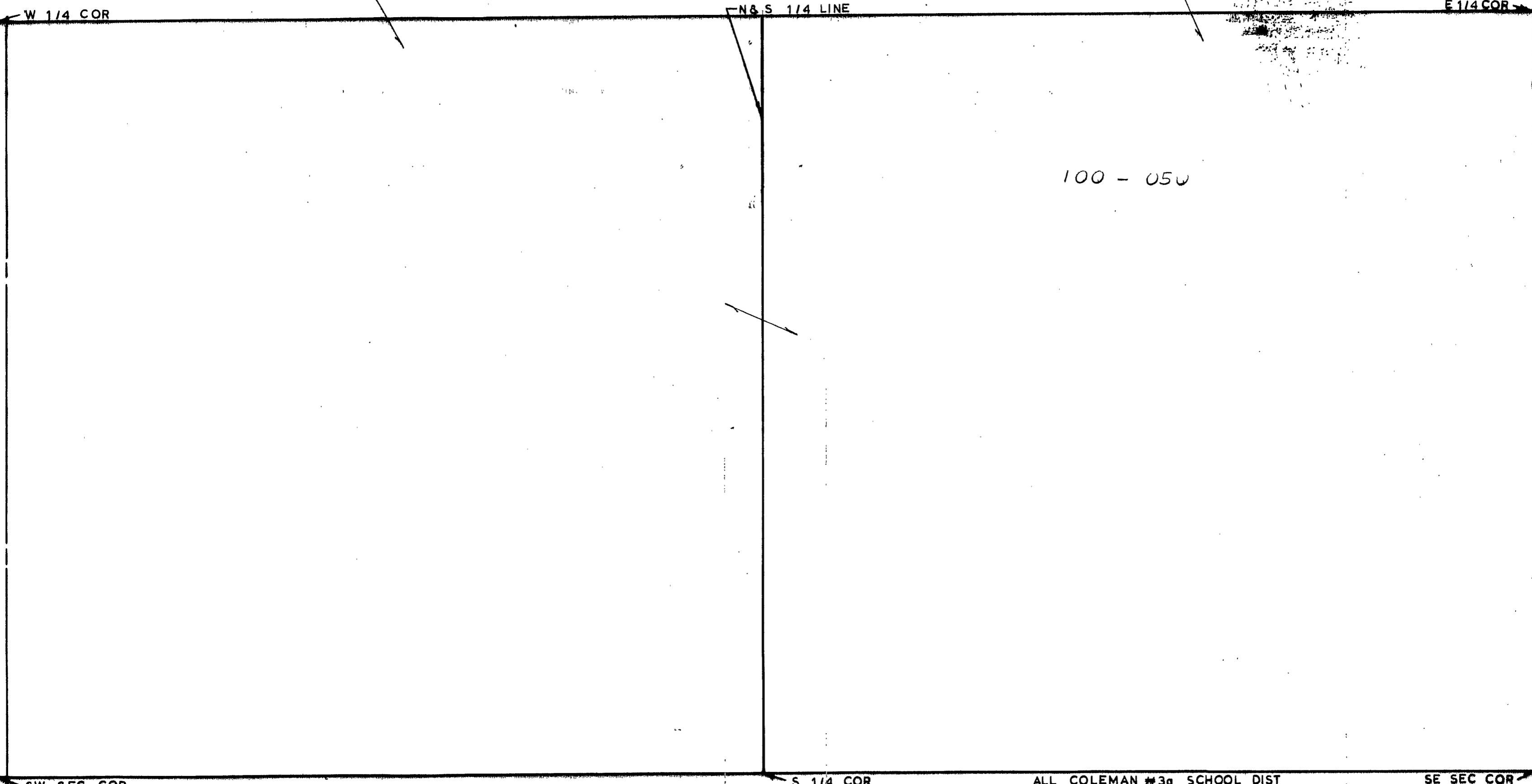

100 - 050

SCALE 1" = 300'
DRAWN BY R.R.Y.

ALL COLEMAN #3g SCHOOL DIST

T 15N R 2W

GENEVA TOWNSHIP

REV. S1/2SEC 29