

MIDLAND COUNTY
Assessment Department
1112 JAMES SAVAGE ROAD
MIDLAND, MI 48640

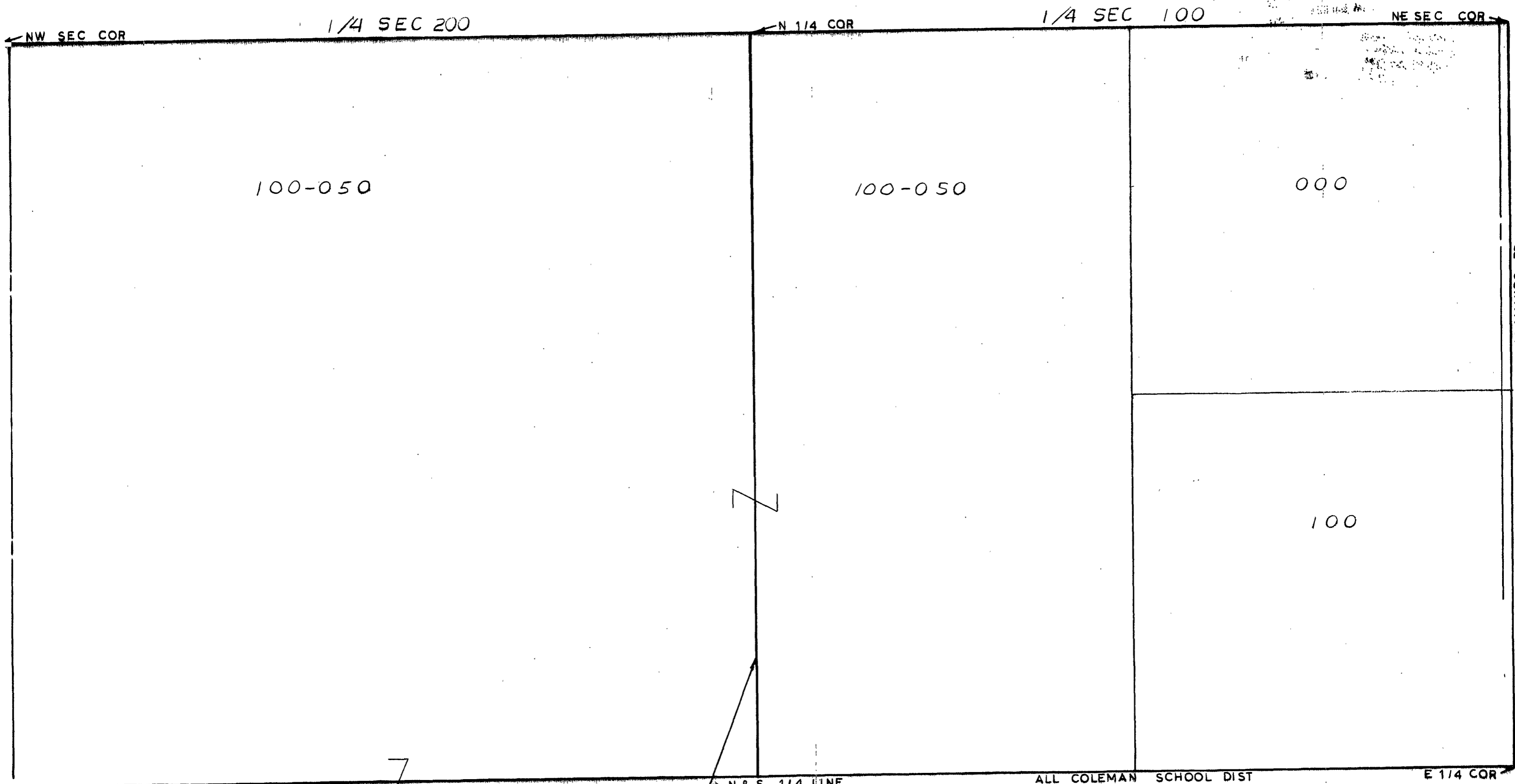

N & S 1/4 LINE
SCALE 1" = 300'
DRAWN BY R.R.Y.

T 15N R2W

GENEVA TOWNSHIP

REV. 11-21-79
N1/2SEC27