

MIDLAND COUNTY  
Equalization Department  
1212 S. Savage Road  
Midland, TX 79701

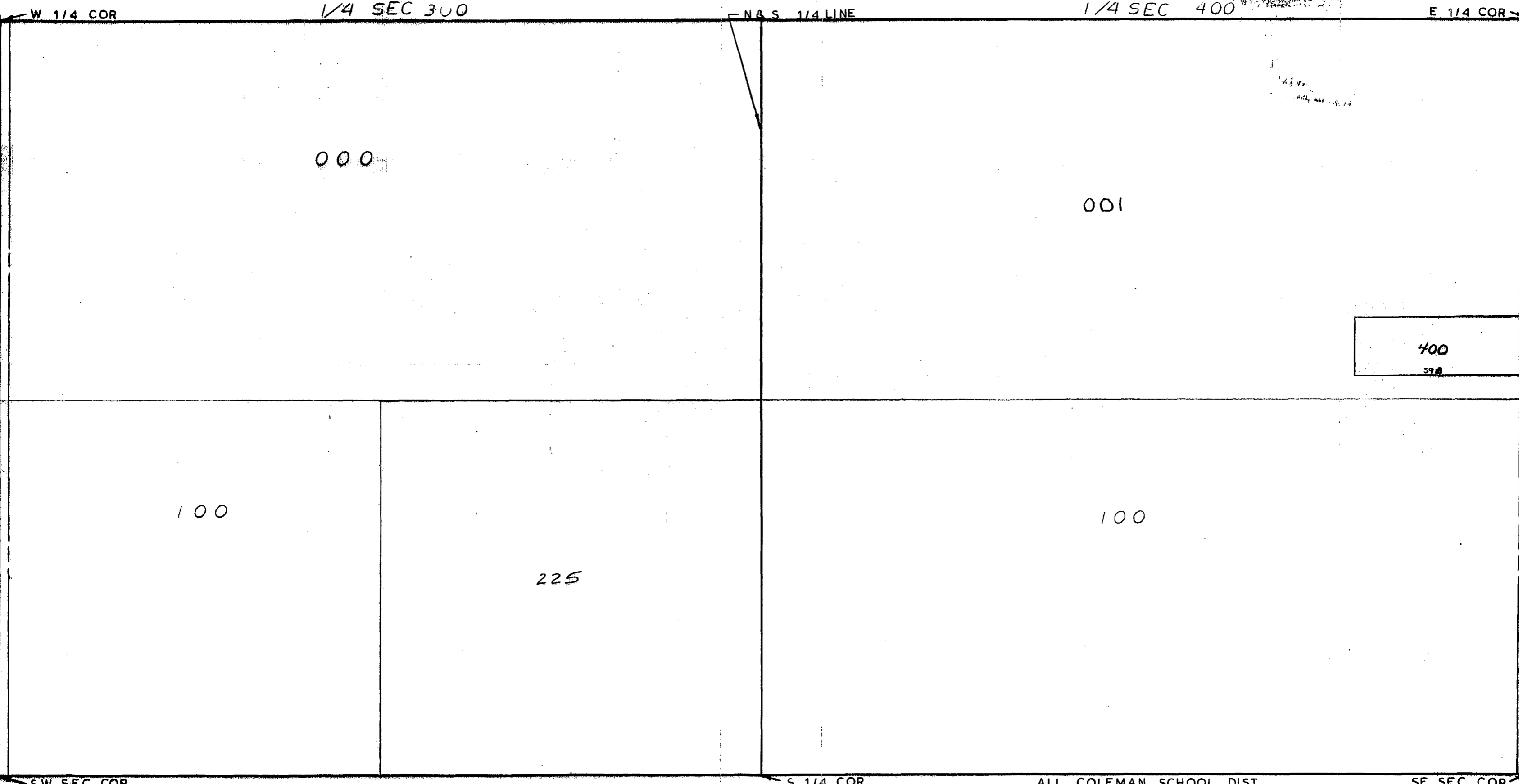

W 1/4 COR      1/4 SEC 300      N & S 1/4 LINE      1/4 SEC 400      E 1/4 COR

000

001

400  
598

100

225

100

SW SEC COR      S 1/4 COR      ALL COLEMAN SCHOOL DIST      SE SEC COR

SCALE  
DRAWN BY R.R.Y.

T 15N R2W

GENEVA TOWNSHIP

REV. 12-11-03  
S1/2SEC22