

MIDLAND COUNTY
Equalization Department
1212 James Savage Road
Midland, MI 48640

1/4 SEC 300
2457'

1/4 SEC 400

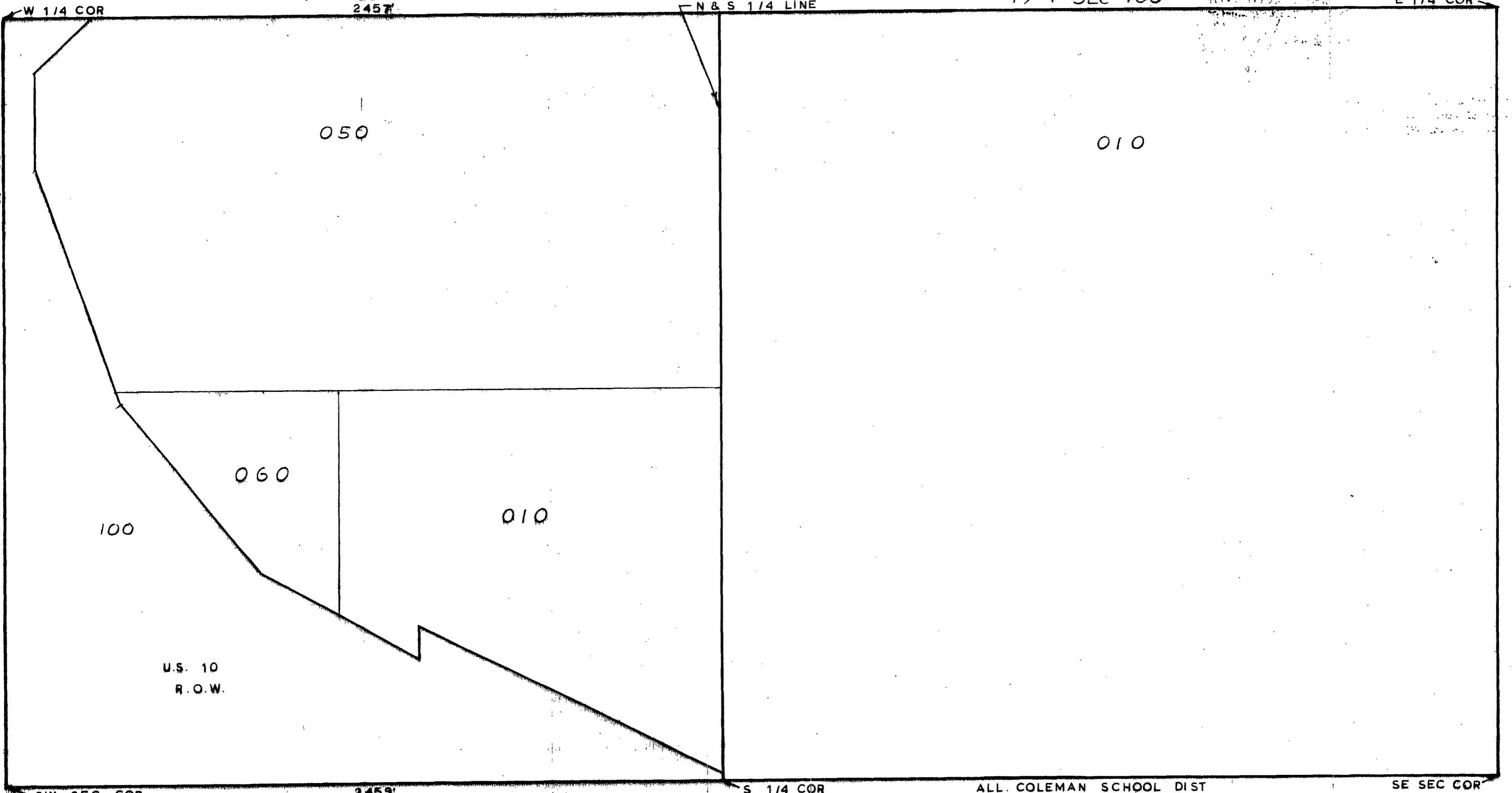

M-19

SCALE
DRAWN BY R.R.Y.
S 1/4 COR
1" = 300'

ALL COLEMAN SCHOOL DIST

T 16N R 1W

EDENVILLE TOWNSHIP

REV. 5/2 SEC 31