

MIDLAND COUNTY
Equalization Department
1212 James Savage Road
Midland, MI 48640

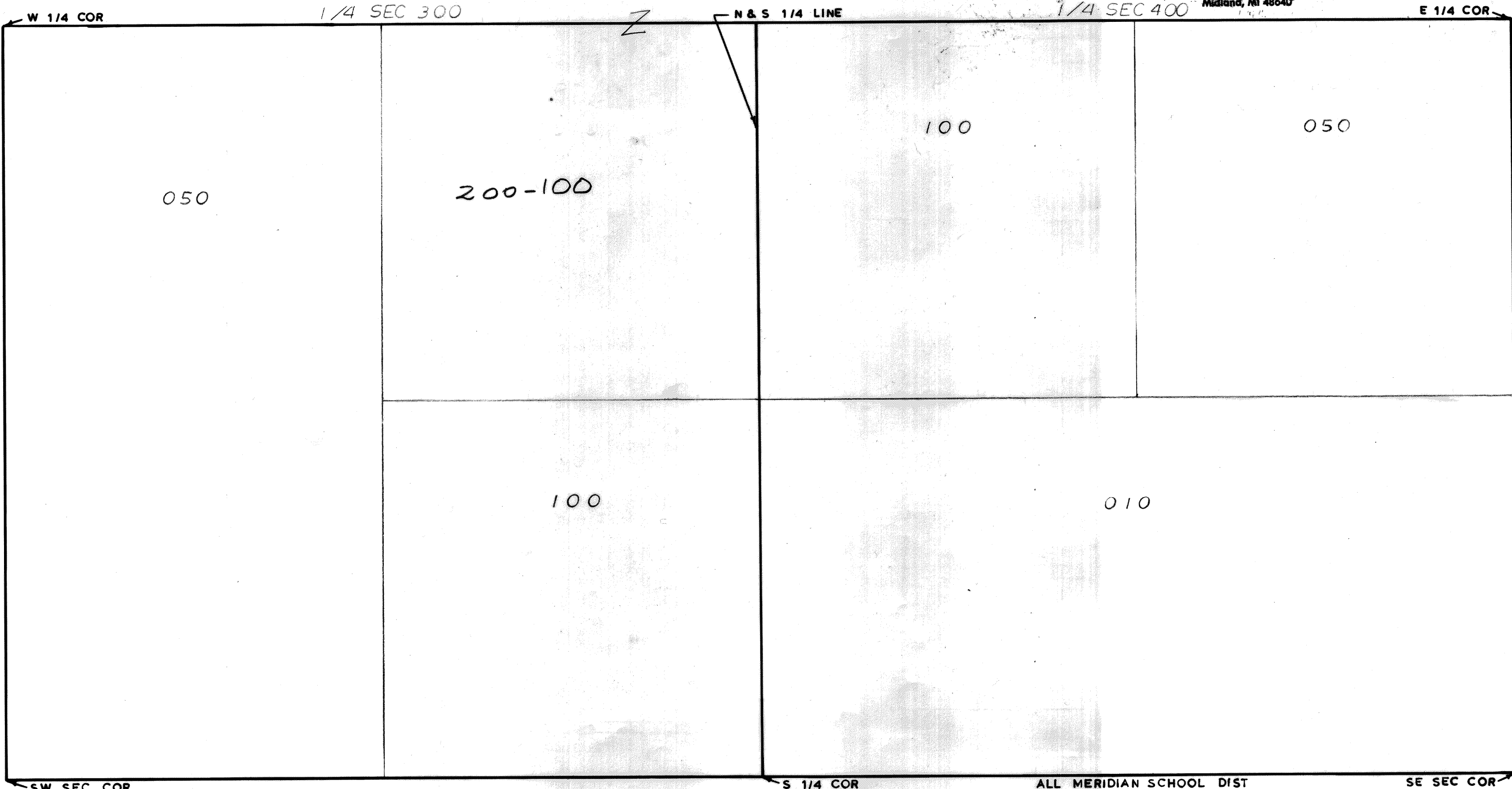

1/4 SEC 300

1/4 SEC 400

050

200-100

100

050

100

010

W 1/4 COR

E 1/4 COR

SW SEC COR

SE SEC COR

S 1/4 COR
SCALE 1" = 300'
DRAWN BY R.R.Y.

ALL MERIDIAN SCHOOL DIST

T 16N R 1W

EDENVILLE TOWNSHIP

REV. 12-16-09
S 1/2 SEC 17